



021 461 7200

sales@flexachem.com



Pharmaceutical + Biotechnology Projects
Flexachem support

Flexachem.com

PUMPS - SEALS - VALVES - PROCESS EQUIPMENT



Summary

- Privately owned Cork based company founded in 1982
- The company portfolio delivers expertise for our customers across all business sectors
- Product focus of **Safety** through **Reliability** of performance – Giving our customers improved Uptime
- Focused portfolio support via dedicated teams in Process Equipment, Valves, Pumps & Mechanical Seals

Flexachem.com

PUMPS - SEALS - VALVES - PROCESS EQUIPMENT

- Chemical
- Pharmaceutical
- Biotechnology
- General Process Industries
- Refinery plants
- Energy generation
- Paint
- Cosmetics
- Food and Beverage
- Meat Processing
- Water & Waste Water treatment
- Steam & Utility Applications
- Contractors & Process Skid Builders





Partnership approach
with our clients to
deliver engineered
solutions to meet
your application &
performance needs –
from component to
project turnkey

General summary

Process

- Tank Solutions - including Bioreactors, SS316 Production Skid packages, Glass lined vessels
 - Filter dryers, Tank Agitators, Heat exchangers, Product blending & CIP Skids
- Tank cleaning, Cooling Towers, Purified Water Generators, Solvent recovery & Thermal separation
- Pipeline solutions & Corrosive applications including bellows, sight glasses..

Valves

- Alloy
- Lined
- Actuated
- Control

Pumps

- Centrifugal
- Vacuum
- Positive displacement

Seals

- Agitator seals
- Pump seals

Sanitary components

- Fittings & couplers
- Diaphragm valves



Filter Dryers



Glass lined reactors and vessels



Magnetic drive agitators



Top entry agitators

Product Handling

Thermal Separation & Solvent recovery





Pure steam generator & WFI Generation systems

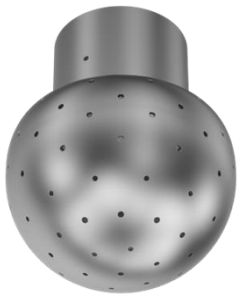

Class 1



Class 2



Class 3



Class 4



Class 5

Tank Cleaning



Filters + Strainers



Tank Level Gauges



Sight glasses



Expansion Bellows



Pipeline & Tank components

Filling Line Solutions – Ceramic lined Pumps & Valves

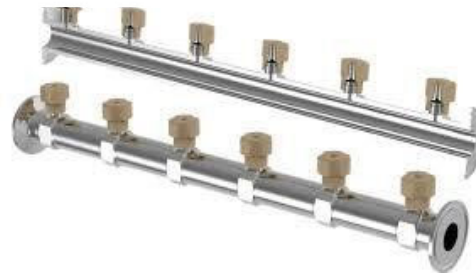

Cone blenders



Product vessels



Production solutions



CIP skids



Skid based solutions

Product Heat Exchangers & Heating/Cooling Skids

Kelvion



AMETEK[®]
FLUOROPOLYMER PRODUCTS



Cooling Towers



Kelvion



**THERMAL
SOLUTIONS**



SMART



Industrial Chillers – Oil Free operation

- Range up from 250 kW & customised units of over 3.2 MW
- Rapid Shipment [RS] series available
- Air cooled & Water cooled options
- All RS units utilize low-GWP R1234ze refrigerant, with R515B available as an alternative

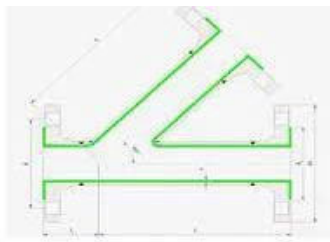
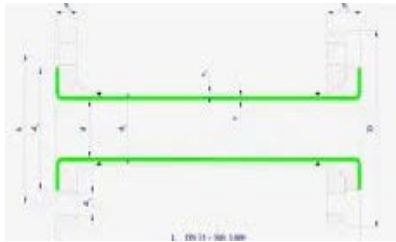

The specialists
in ptfе piping!

Corrosion resistant pipework



Diaphragm Valves

FLOWSERVE

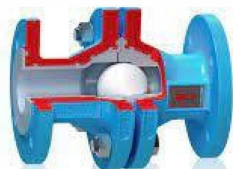





Vacuum + Centrifugal pumps

- Durco Mark3 Process pumps
- Innomag Magnetic drive Sealless pumps
- SIHI Vacuum pumps
- Seal pots
- Commissioning & Alignment

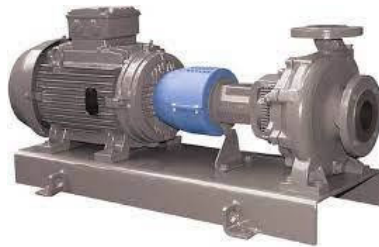



Sanitary Rotary lobe and Centrifugal pumps

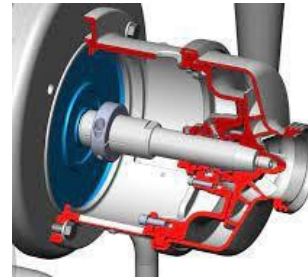

NETZSCH



Progressive Cavity



Rotary Lobe



Peristaltic

Transfer pumps – Pharma



Mechanical Seals



Flame Arrester



Venting



Bursting discs

Vapour control

Project Flow

Basic Process Flow Diagram

- Define basic volumes, flow rates and pipeline sizes end to end

Detailed Process Flow Diagram

- Evolved specification and URS development
Mechanical specifications

Overlay P&ID

- Inclusion of instrumentation, control and automation

Specification for enquiry

- Bill of materials listing
- Partnership commentary and submission of costs
- PO discussion

Equipment schedule

- Delivery
- Install
- Close out



Technical Comment

We encourage discussion on options to maximise efficiency & optimise the budget

ATEX discussions will have a bearing on solutions offered

Lead times options will also be tabled

Site commissioning and sign off protocol to be agreed per product type in advance of purchase

Service engineers subject to our partners rate of site costs

Lead times

- Depends on the capital equipment type
- Longer lead items are typically filter dryers, glass lined vessels, agitators, cooling towers, aeration systems, some pumps
- Most other items fall into the 6-16 weeks bracket for delivery once specifications are known & confirmed with the factory
- Lead times are dependent on specifications agreed for the duties, factory loading, materials availability, payment stages and client approval for any drawings relevant for manufacture



Finance

- Once overall budget is worked out this can be discussed
- A value package will also be available for multiple equipment spend
- Typically for CAPEX spend, stage payments will be involved
- Formal Purchase Order required for ISO audit purposes



Flexachem Project Support

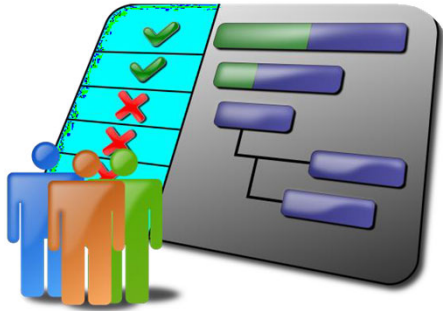

Front End
Discussions

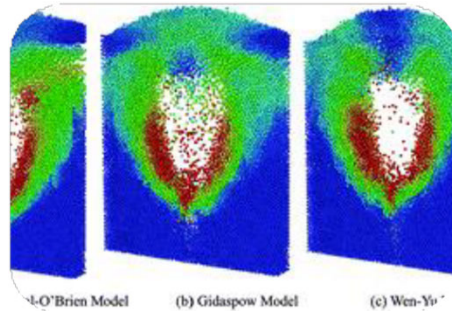

Improvement &
Optimisation



Site
commissioning



Aged or
Obsolete goods



Value packages



Turnkey
Projects



Pilot plant

Flexachem portfolio Support

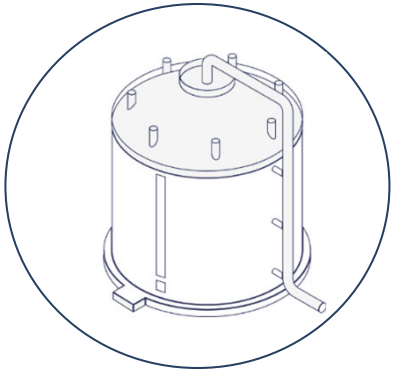

PROJECT LEAD & PROCESS EQUIPMENT

Michael Bradley

Michael.Bradley@flexachem.com
Mobile +353 86 0476178

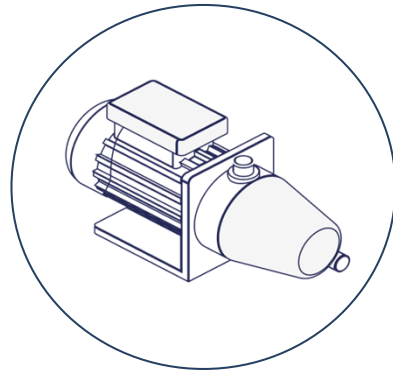

PUMPS

Andrew Bishop

Andrew.Bishop@flexachem.com
Mobile +353 83 0891204

Phil Soltan

Phil.Soltan@flexachem.com
Mobile +353 86 1853782

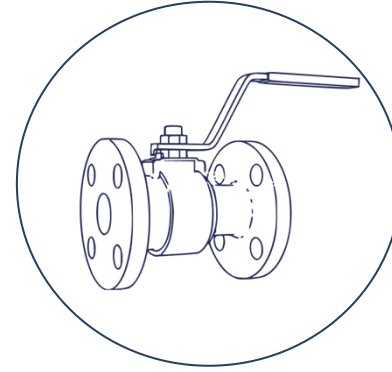

VALVES & SALES LEADS

Brendan Merrigan

Brendan.Merrigan@flexachem.com
Mobile +353 87 2598124

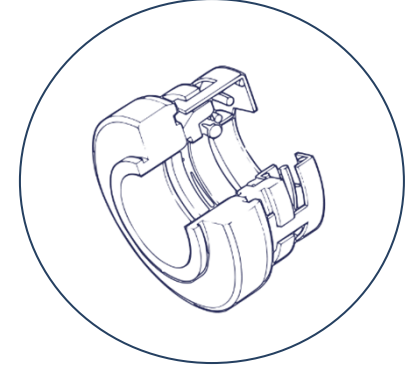

MECHANICAL SEALS

Chris Sheeran

Chris.Sheeran@flexachem.com
Mobile +353 87 7559936

