

SANITARY RISING STEM SAMPLING VALVE



BREWING
BEVERAGE



DAIRY
FOOD
WINE
PHARMACEUTICAL
BIOTECHNOLOGY

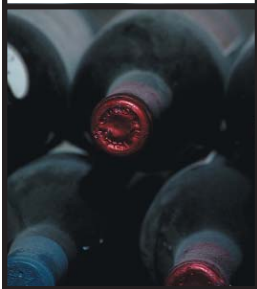
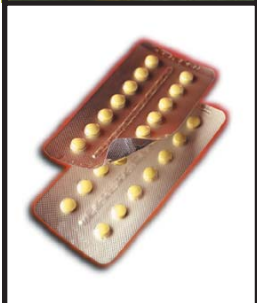
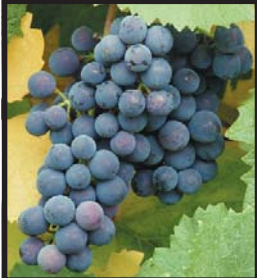

SANITARY RISING STEM

SAMPLING VALVE

PBM's Sanitary Sampling Valve product line is specifically designed for taking process samples in breweries, wineries, food and beverage manufacturing facilities, as well as in pharmaceutical, biotechnology, chemical and cosmetic manufacturing to ensure quality, consistency, taste, sterility.

Sampling is extremely important at all stages of production, as it allows for trials and analyses and is often the way a potential problem is caught.

The Sanitary Rising Stem Sampling Valve has minimal moving parts, simple design, competitive price, and proven cleanliness in process manufacturing.



QUALITY

consistency

STERILITY

reliability





◀ Typical sampling valve with 1/2" Tri-Clamp® inlet and outlet



▶ Sampling valve with optional tamper-resistant locking knob cover

▼ Optional inline version



▶ Economic short version without split body

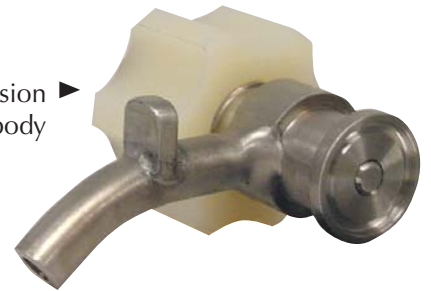

Flow Coefficient (Cv) testing of the PBM Sanitary Rising Stem Sampling Valve

Total full open Cv is about 1.0 gpm. The Cv of PBM's Sanitary Rising Stem Sampling Valve has a gradual increase between just off closed to 1¼ turns open, making it extremely controllable.

Cv vs. Position				
Actuated Valves			Manual Valves	
Adjusting Screw or Knob (Turns Out)	Swickle Outlet	Hose Barb Outlet	Swickle Outlet	Hose Barb Outlet
None	0.00	0.00	0.00	0.00
1/8	0.09	0.13	0.01	0.07
1/4	0.10	0.13	0.08	0.15
3/8	0.10	0.16	0.04	0.16
1/2	0.10	0.16	0.22	0.23
5/8	0.12	0.16	0.37	0.30
3/4	0.14	0.19	0.48	0.44
7/8	0.27	0.23	0.60	0.51
1	0.44	0.33	0.68	0.63
1-1/4	0.66	0.53	0.86	0.78
1-1/2	0.81	0.66	1.00	0.83
1-3/4	0.95	0.79	1.07	0.90
2	1.04	0.85	1.11	0.90
2-1/2	1.05	0.86	1.12	0.90
3 or more	1.05	0.86	1.12	0.90

Breweries

Wineries Beverages



Successful breweries, wineries and other beverage manufacturers recognize the importance of using high-quality ingredients, reliable technology and paying attention to detail. Using PBM's Rising Stem Sampling Valve with a swickle outlet helps ensure that results are the same regardless of the observer.



features

- 316L Stainless Steel
- Swickle Outlet
- No tools required for disassembly
- Product line or vessel connection 1/2-inch weld, 1/2-inch clamp, 1 1/2-inch clamp
- 3/8-inch male pipe straight thread
- Large Nylon 6/6 knob
- Quick disassembly for inspection or cleaning by removal of 1/2-inch body clamp
- Viton or EPR O-ring and body gasket
- TFM® seat
- 32 Ra ID wetted surfaces
- Autoclavable. Assembled or disassembled.
- All FDA compliant materials

MANUAL VALVES

Flow direction through the valve is from below the stem, through the body of the valve, and out the open discharge end of the valve (swickle, hose barb end or other). The valve is designed for use at liquid pressures from full vacuum to up to 100 psig (6.9 barg) and temperatures of up to 250°F (121°C). The valves are also capable of operation in saturated or superheated steam at up to 350°F (177°C).

OPTIONS

- Tri-Clamp® Inlet
- Tri-Clamp® or Hose Barb Outlet
- Optional SIP/CIP ports
- Locking tamper-resistant plastic cover
- Finer finishes, ID and OD, and electropolishing



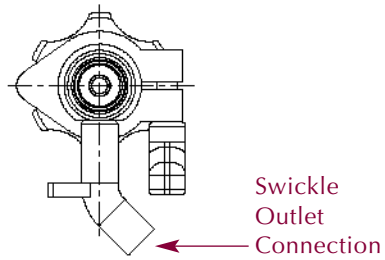
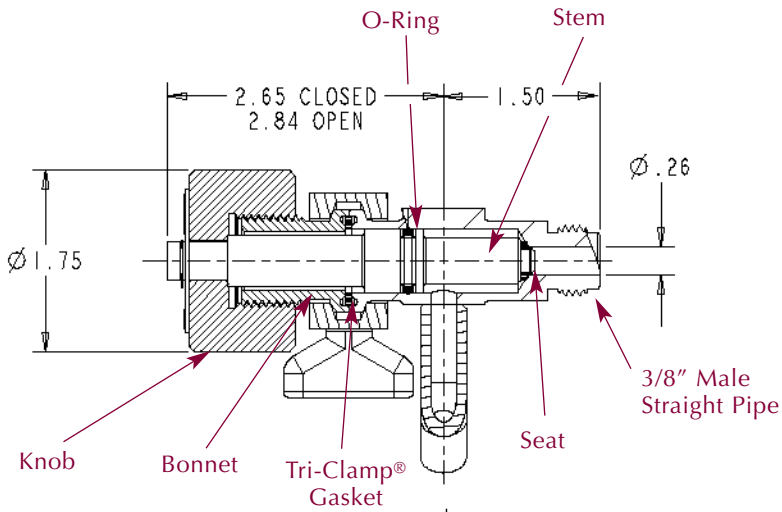

SAMPLING VALVE ASSEMBLY

- with 3/8-inch male pipe inlet
- Swickle Outlet
- Viton O-Ring
- TFM® Seat
- Manually Operated

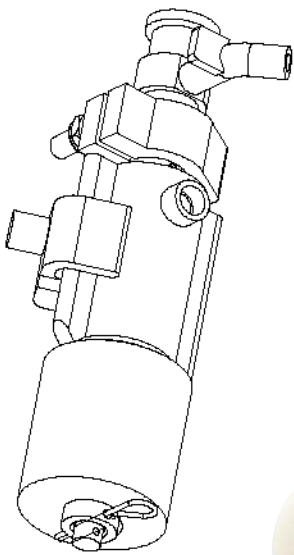
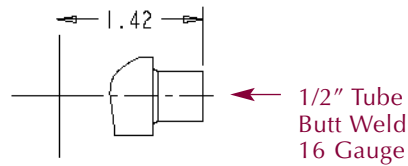
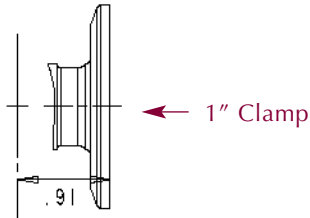
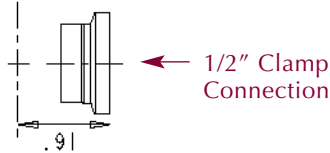

ACTUATED VALVES

The actuator is single acting, pneumatic and is spring return to the closed valve position and operates with 50 to 120 psig air pressure. A 1/4-inch FNPT tap is provided for connecting the air line from the solenoid valve. It features an adjustment to set full open flow to the desired level. This flow can be adjusted from a trickle flow to as much as 5 gpm at 25 psi pressure drop. A knob is provided to operate the valve manually in lieu of operating the valve with air.

Position of the valve can be detected with one or two IFM Efecto MK 5005 proximity switches that sense the position of a magnet above the piston in the valve. These low current switches operate at voltages of 10 to 30 VDC.

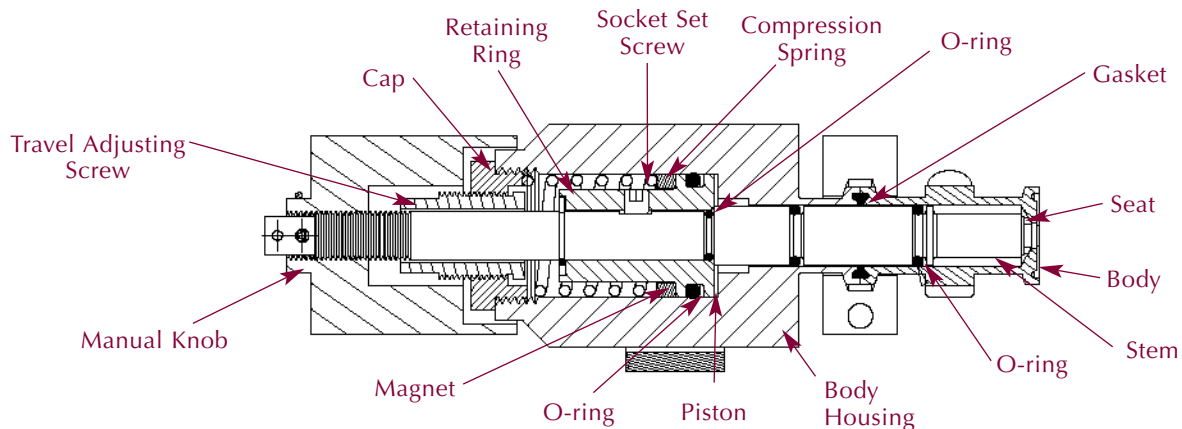



PBM's Rising Stem Sampling Valve design with a hose barb outlet is ideal for taking process samples in the pharmaceutical, biotechnology, chemical, and cosmetic manufacturing industries. The valve design is simple and clean. Simply turning the knob raises a stem with a TFM® seat seal. The stem is sealed with an FDA compliant Viton or EPR O-ring.



features

- 316L Stainless Steel
- Hose barb outlet for 1/4-inch ID hose
- No tools required for disassembly
- Product line or vessel connection 1/2-inch weld, 1/2-inch clamp, 1 1/2-inch clamp
- Large nylon 6/6 knob
- Quick disassembly for inspection or cleaning by removal of 1/2-inch body clamp
- Viton O-ring and body gasket
- TFM® seat
- Autoclavable, assembled or disassembled.
- Meets 3A requirements
- All materials are FDA compliant
- 32 R_a ID wetted surfaces

MANUAL VALVES

PBM's Sanitary Rising Stem Sampling Valve provides consistent cleanability and sterility in industries where sanitary manufacturing conditions are of the utmost importance.

OPTIONS

- Tri-Clamp® Inlet
- Tri-Clamp® or Swickle Outlet
- Tri-Clamp® Purge Port connection
- Optional SIP/CIP ports
- Locking plastic cover
- Finer finishes, ID and OD, and electropolishing

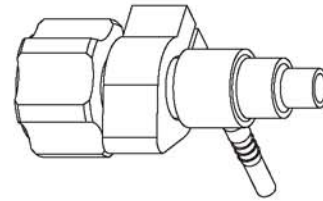
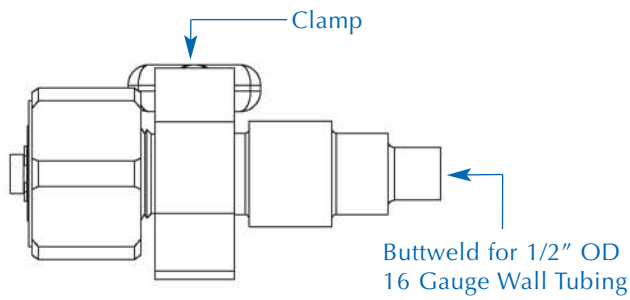

SAMPLING VALVE ASSEMBLY

- with 1/2-inch buttweld for tubing inlet
- Hose Barb Outlet for 1/4-inch ID hose
- EPR O-Ring
- TFM® Seat
- Manually Operated

ACTUATED VALVES

The actuator is single acting, pneumatic and is spring return to the closed valve position and operates with 50 to 120 psig air pressure. A 1/4-inch FNPT tap is provided for connecting the air line from the solenoid valve. It features an adjustment to set full open flow to the desired level. This flow can be adjusted from a trickle flow to as much as 5 gpm at 25 psi pressure drop. A knob is provided to operate the valve manually in lieu of operating the valve with air.

Position of the valve can be detected with one or two IFM Efector MK 5005 proximity switches that sense the position of a magnet above the piston in the valve. These low current switches operate at voltages of 10 to 30 VDC.

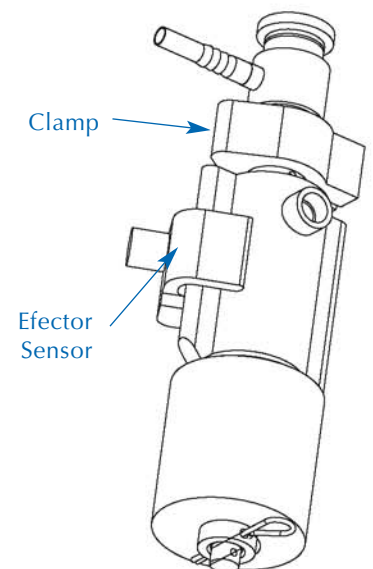
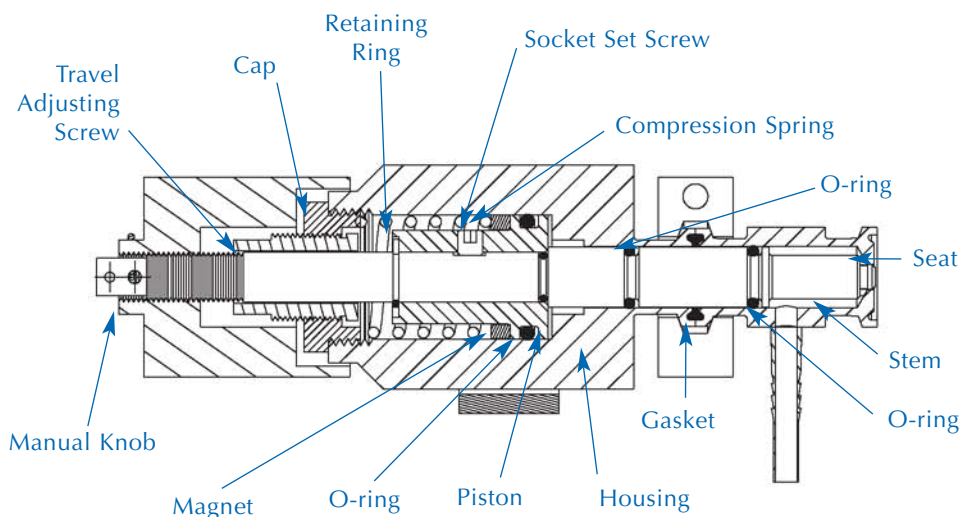
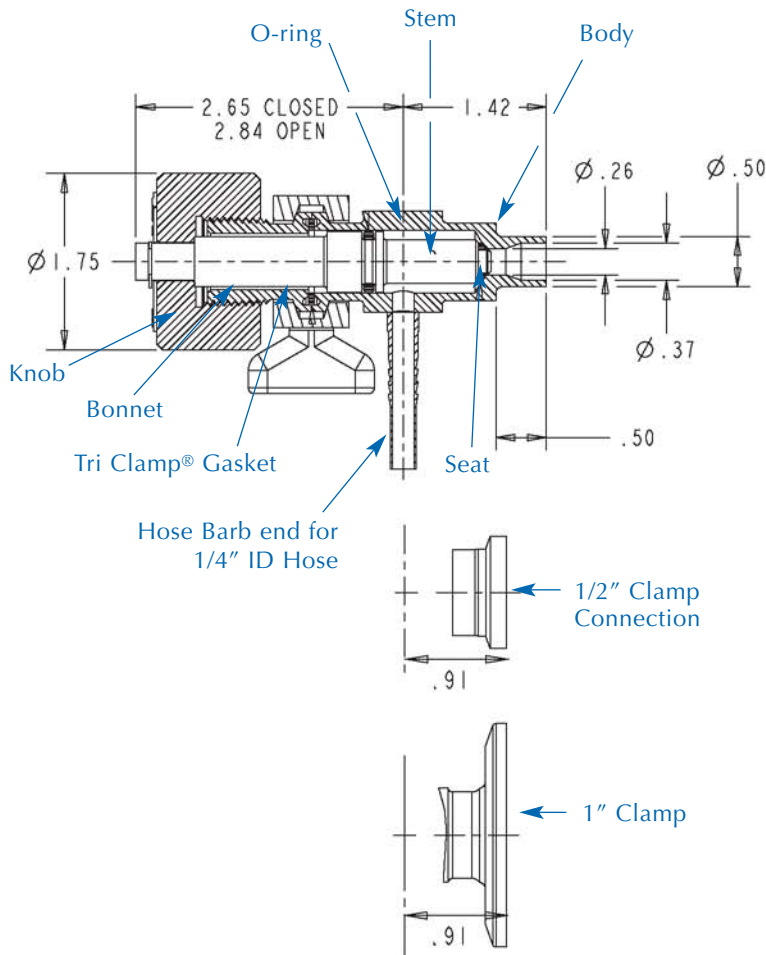

ABOUT PBM

PBM offers a comprehensive product line for optimum performance in controlling and automating process lines. Our valves minimize contamination, comply with sanitary regulations, facilitate clean-in-place, solve clogging problems and reduce downtime. PBM's engineering and manufacturing teams will work with you to design special valve configurations.

Exceptional value, reliability and service that customers have relied on for over 100 years. You shouldn't expect anything less from a leading manufacturer of dependable, high quality valves. Call 800-967-4PBM to speak to a sales representative, or e-mail PBM with questions or a quote request at info@pbmvalve.com.



Sampling Valve Part Number

how to order

Sampling Valve has 1/4-inch bore inlet diameter.
Number in "()" represents part number character position.

Product Code (1-2)	Material (3-4)	Inlet Size (5)	Inlet Type (6)	Outlet Size (7)	Outlet Type (8)	Seat/Seal Code (9)	Purge Qty/Location (10)	Purge Type/Size (11)	Actuation (12)	Polish Options (15)
S-	HL 316L	A 1/4"	X Tri-Clamp®	A 1/4"	X Tri-Clamp®	A TFM®, Viton	- None	A 1/4" Hose Barb	- None	- 32 R _a ID
		H9 A479, S31603 (wrought 316L)	B 3/8"	P Male NPT	B 3/8"	P Male NPT	B TFM®, EPR	A One	B 1/2" Tri-Clamp®	A Actuator
S2	HL 316L	C 1/2"	F Butt Weld	C 1/2"	F Butt Weld	C TFM®, EPDM		C 1/4" FNPT		B 15 R _a ID after electropolish
		D 3/4"	G Straight Thread	D 3/4"	H Hose Barb	D TFM®, Kalrez		D 1/8" FNPT		C 10 R _a ID after electropolish
S3	HL 316L	E 1"		E 1"	S Swickle			E 1/2" Tubing		D 20 R _a ID & 32 R _a OD after electropolish
		G 1-1/2"		G 1-1/2"						F 20 R _a ID after electropolish
		H 2"								H 10 R _a ID after electropolish

Ordering Example

1 + 2	3 + 4	5	6	7	8	9	10	11	12	15
Product	Material	Inlet Size	Inlet Type	Outlet Size	Outlet Type	Seat & Seal Code	Purge Quantity & Type	Purge Type & Size	Actuation	Polish
S-	HL	C	X	A	H	A	-	-	-	A

S-HLCXAHA - - A is the code for a Sampling Valve (1/4-inch diameter inlet hole), 316L grade stainless steel, with a 1/2-inch Tri-Clamp® inlet and a 1/4-inch hose barb outlet, TFM® seat and Viton O-ring and body seal, with 20 R_a ID mechanical polish.



PBM, Inc.
1070 Sandy Hill Road • Irwin, PA 15642 • USA
Toll Free: 1.800.967.4PBM
Phone: 724.863.0550 • Fax: 724.864.9255
e-mail: info@pbmvalve.com • www.pbmvalve.com

