

## Application

The PEMS II valve is a process line accessory to be used for clear or viscous liquid products from group 2. It is designed to meet the need to take samples from liquid process installations in the food, chemical, pharmaceutical, cosmetics and biotechnology industries as well as all other sectors requiring sanitary type equipment.

## Operating principle

The PEMS II valve is both reliable and easy to use. The sample is obtained by turning the control screw to detach the membrane from its seat so as to allow the fluid to enter the outlet pipe. It is designed to be flame sterilised.

No tools are needed to maintain the PEMS II, unscrewing the knurled mating head gives direct access to the membrane.

## Standard definition

The PEMS II valve is a process line accessory in accordance with European pressure equipment directive 97/23/CE paragraph 3.3. It comprises a stainless steel body, either attached to piping or to a tank, AND a stainless steel head to which the ball-gasketed membrane is mounted. The standard valve is delivered with plain ends for welding on the inlet side and a smooth pipe on the outlet side.

## Materials

Components in contact with the product being conveyed: 1.4404 (316L) stainless steel.

Membrane: silicone.

Finish: semi-bright.

## Sizes

Standard NW 6 and NW 10 for highly viscous liquids.

## Technical characteristics

Max. operating pressure: 600 kPa (6 bar).

Operational temperature range: 0°C to + 100°C.

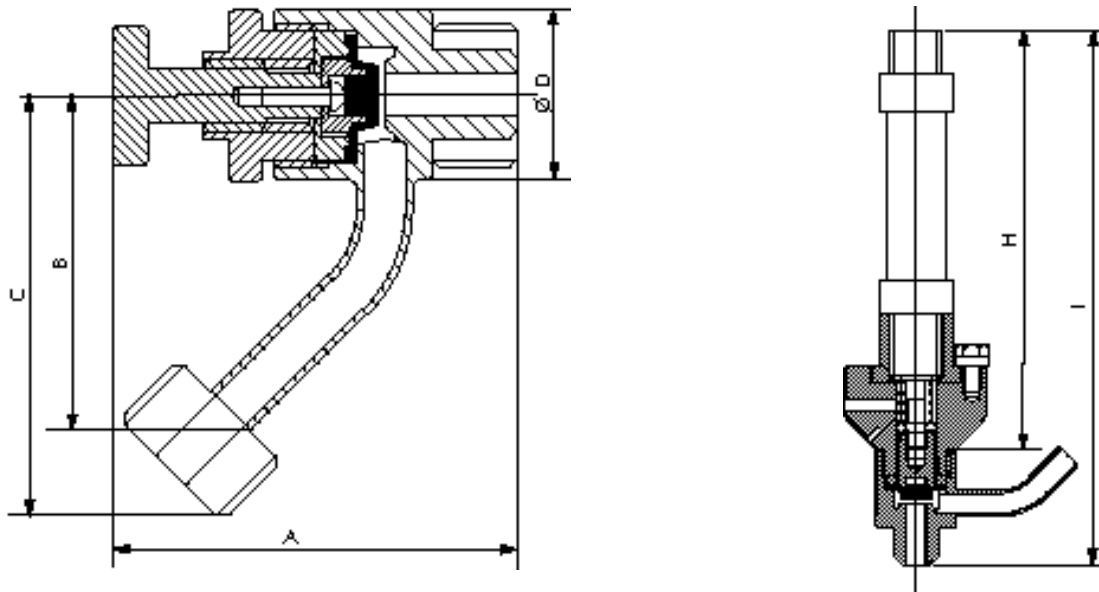

**Table of dimensions (mm)**

Sizes	NWN6	NW10
A	59	85
B	52	57
C	60	68
D	24,5	34,5
Weight ( kg)	0,135	0,46
E	81	
12	12	
G	21,5	
H	129	188
I	163	236

## Options

- A) Threaded inlet: 1/4"\* , 3/8" , 1/2" or other connection on request.
- B) Threaded outlet: 1/4"\* , 3/8" , 1/2" or other connection on request.
- C) Membrane in EPDM, FPM (VITON equivalent), Perbunan (nitrile).
- D) Two smooth or threaded outlets (1/4"\* , 3/8" , 1/2") for CIP sanitation or steam sterilisation.
- E) Single action pneumatic actuator (NC).
- F) Safety head with female 6-sided nut.

\* NW 6 only.

## When ordering, please provide the following information:

- Size.
- Type of inlet connection if other than plain to be welded.
- Number and type of outlet(s).
- Membrane quality.
- Manual or pneumatic version.

## Note:

For further details, refer to the PEMS II sample valve spare parts catalogue and installation manual.

We reserve the right to modify our products without notice, including those for which orders have already been placed.

**SERVINOX**

7, avenue Georges Politzer - 78197 Trappes cedex - France

Tél. : + 33 (0)1 30 16 15 00 - Fax : +33 (0)1 30 16 15 01

Email : mail@servinox.com - Homepage : <http://www.servinox.com>

**PES 09 D GB**